

PF



User Manual

User Manual-PF 16-0015- ver.5
Worldwide Patent Pending

INDEX:

1.1.	INTRODUCTION.....	3
1.2.	SPECIFICATION.....	4
1.3.	WORK INSTRUCTION	4
1.4.	STORAGE.....	5
1.5.	SAFETY DIRECTIVES.....	5
1.6.	INSPECTION AND MAINTENANCE	5
1.7.	EF-DECLARATION.....	6
1.8.	CE-DECLARATION	7



1.1. INTRODUCTION

The PF WLL 2 ton is designed to lift EUR pallets on construction sites requiring high security when lifting to height. This lifting equipment is used as safe lift coupling with standard EUR pallets (800x1200).

The lifting beam is attached to a crane with a four-point chain. This chain can be adjusted in length depending on the load to be lifted. The lifting beam is in two parts. Two PFs as shown on figure number 2.

For lift coupling, a standard chain with min. WLL 2.1 tons and max. 60 degrees angle, is recommended. The length should not be less than 3.5 meters.

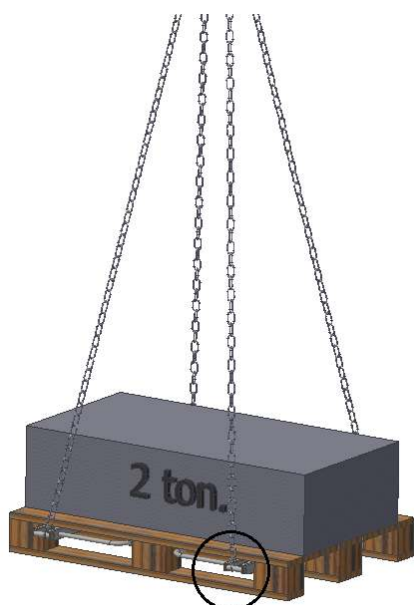

Figure 1



Figure 2

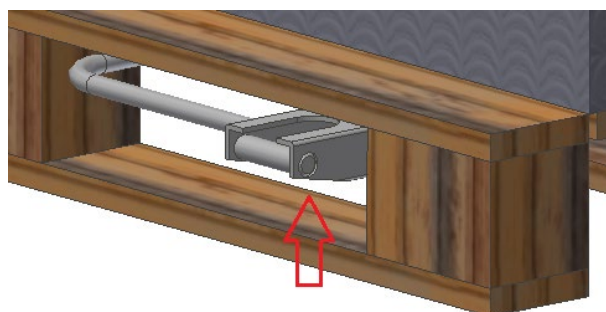

Figure 3

Figure 3 shows correct mounting of a PF. The diagonal cut must face down as shown in the picture, to facilitate insertion in the pallet.

1.2. SPECIFICATION

Type:
Name: PF
Type no.: CRH 800x1200
Serial no.: 0012016
Drawing no: ECA-005
Tara: 2 Ton [metric]
Date: 07.06.2016

Approved by: CRH Concrete A/S
Vestergade 25
DK-4130 Viby

1.3. WORK INSTRUCTION

1. The operator must place the equipment ensuring that there is a clear view of the lifting area.
2. When lifting is in progress, no other work is permitted in or around the lifting area.
3. The operator must be qualified to operate the equipment, and to determine the center of gravity movement, when positioning the chains to ensure that the load does not come out of balance.
4. There must be no oil, mud or ice on PF, to prevent any Pallet movement and dislocation of the load.
5. The PF is mounted in the crane hook only at one end, with the chain first.
6. The PF is lifted to the load by the crane.
7. The PF is secured in the four points for lift coupling.
8. The PF and the load should be positioned on a flat surface to ensure a vertical lift.
9. Prior to lifting make sure, that PF and load remain in horizontal position throughout the entire lift.
10. Before lifting make sure, that the recipient of the load is ready to receive the load.
11. Before lifting make sure, the area where the load is to be set is stable and can withstand the load.
12. Lift the load off the ground approximately 30 cm and ensure that the load is in balance.
13. When lifting the operator must constantly, be in contact with the recipient of the load, so that lifting can be interrupted if necessary.
14. The PF is positioned and kept stable before the next lifting operation.

1.4. STORAGE

PF can be stored outdoors but must be covered and kept dry, as water can affect corrosion treatment.

1.5. SAFETY DIRECTIVES

- PF may be used in air temperatures between -20°C and + 60°C.
- PFs capacity, WLL, must never be exceeded and the loads should always be applied as described.
- Only trained persons may use PF.
- The lift zone must be closed to humans and/or animals when the load is lifting or lowering.
- Do not lift humans and/or animals with the PF.

1.6. INSPECTION AND MAINTENANCE

- Before use, check visually that the PF does not have any visible cracks or deformations.
- Inspection of PF must be carried out once a year by a qualified person.
- If the CE mark is missing or unreadable, PF must not be used before the product is identified and marked again.
- If the equipment is found with cracks or deformations, it must be discarded.

Service schedule

Check points	Annually by trained personnel
Visual inspection of the welding at 20mm tubes. (Lifting point).	X
Cracks or deformations of the RHS profile 80x40x4.	X
Cracks or deformations of 16mm hanger.	X

1.7. EF-DECLARATION

EF - Declaration

Directive 2006/42/EF

Manufacturer: CRH Concrete A/S

Address: Vestergade 25

DK - 4130 Viby

Hereby declares that:

Pallet Finger ECA-005

Type nr: CRH 800x1200

- Is in accordance with the Machinery Directive. Directive 2006/42/EF.

The following harmonized standards were used:

- DS/EN 12100-1:2011 Safety of machinery - General principles for design - Risk assessment and risk reduction
- DS/EN 13155 + A2 Cranes – Safety – Non-fixed lifting equipment for loading.

Approved by:

Location: CRH Concrete A/S

Adresse: Vestergade 25

4130 Viby

Denmark

Date: 09.06.2016

Signature:  _____

Position: Lars Reimer – Technical Manager

1.8. CE-DECLARATION

 Vestergade 25 4130 Viby-DK EN 13155	WLL: 2000 kg		
	Weight: 9 kg		
	Serie No: 0012016		
	Type: ECA-005		
	Year: 2016		

Worldwide Patent Pending.